

PARIS - LONDRES - MOSCOU

Helène Darroze

PARIS - LONDRES - MOSCOU

EVENTS

Paris - London

Helène Darroze

PARIS

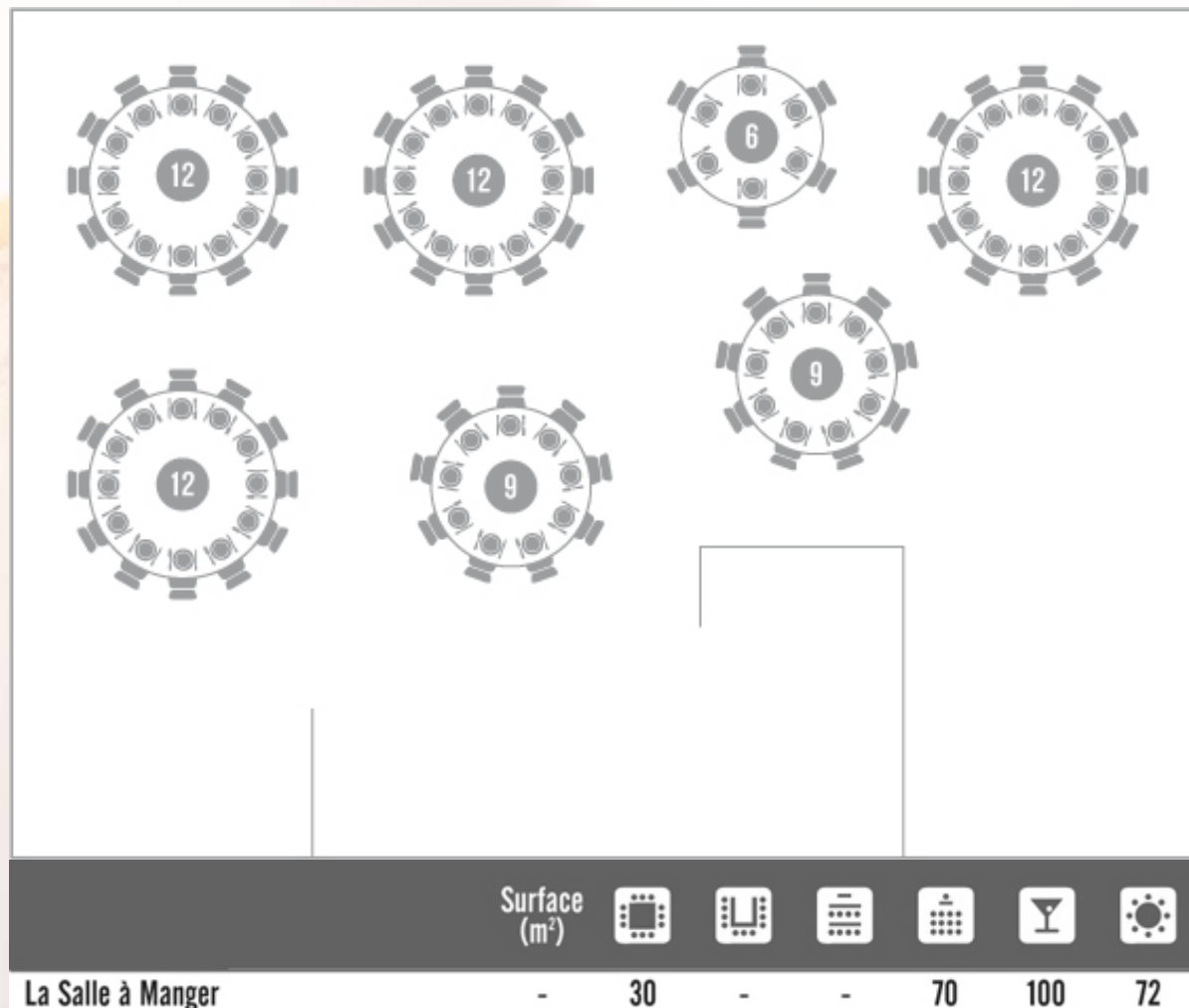

PARIS - LONDRES - MOSCOU

Helène Darroze

PARIS - LONDRES - MOSCOU

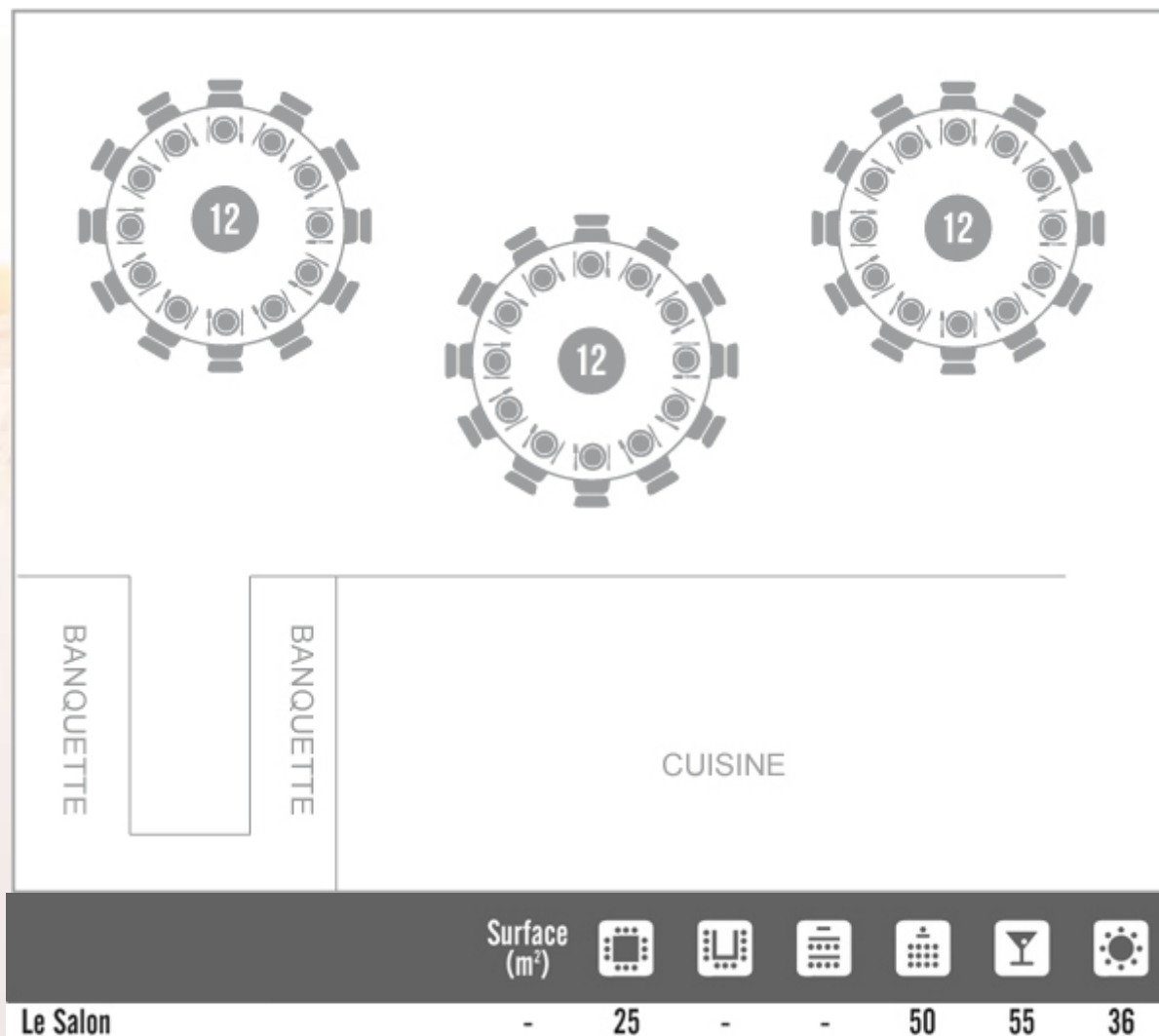

PARIS - LONDRES - MOSCOU

Hélène Darroze

PARIS - LONDRES - MOSCOU

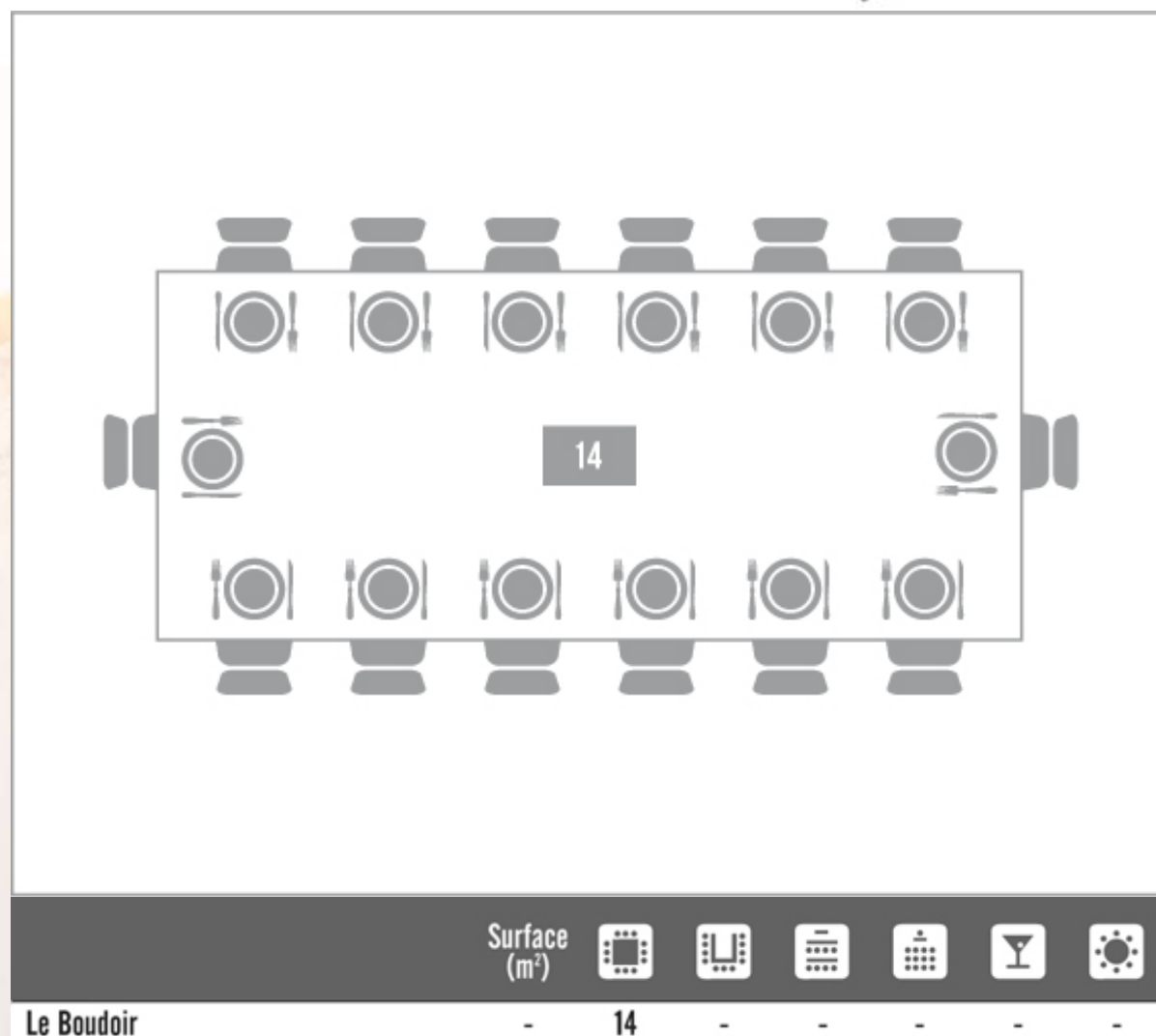

Le Boudoir

LONDON

GENERAL FLOORPLAN

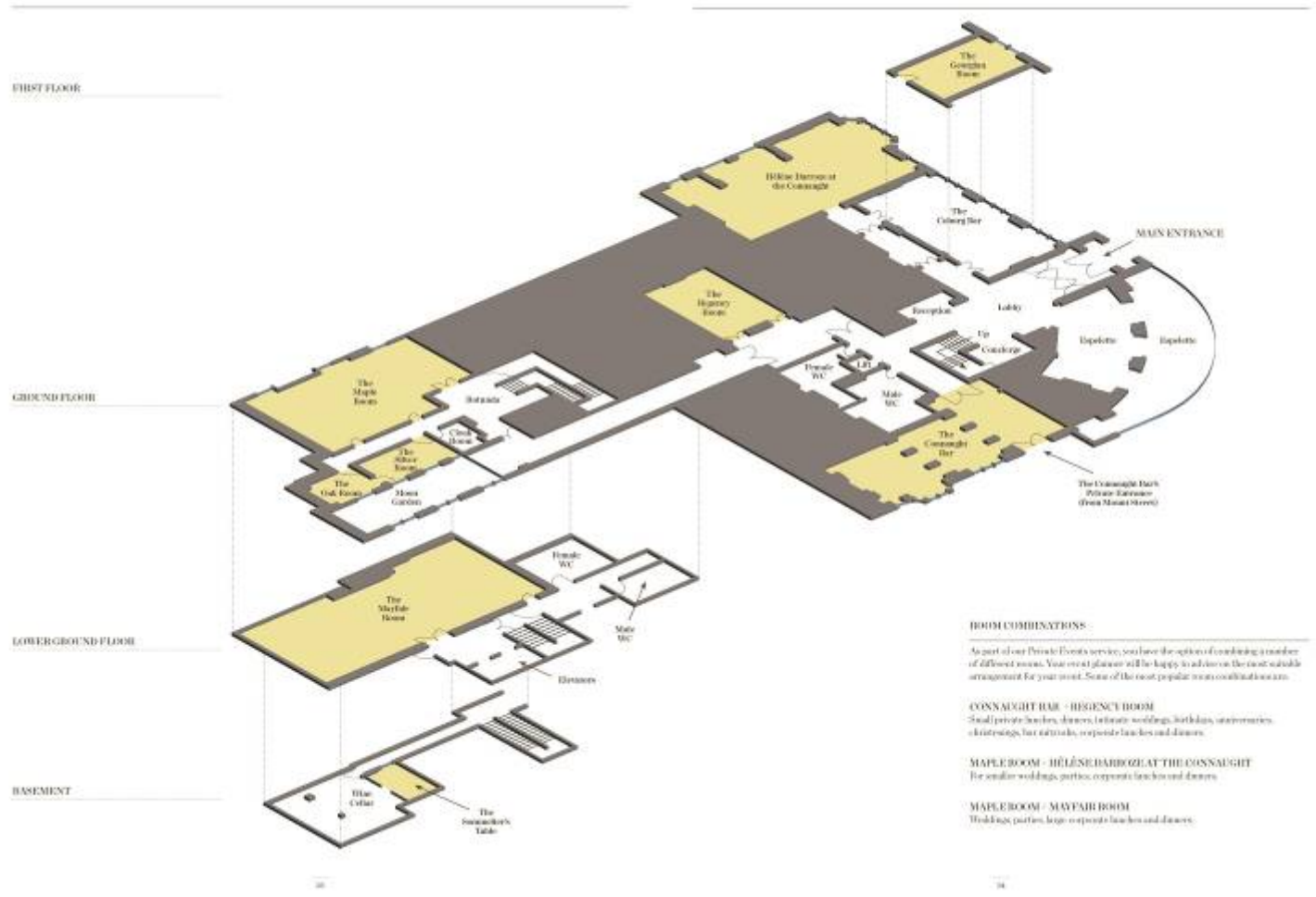

THE MAYFAIR ROOM

CONFIGURATIONS

Reception	200
Dinner	120
Dinner Dance	80
Theatre	120
Classroom	70
Board or Oval	60
Cabaret	60
U Shape	50

MEASUREMENTS

Dimensions	18 x 8 m / 59 x 26 ft
Total Area	151 m ² / 1625 ft ²
Ceiling Height	3.6 m
MAYFAIR ROOM 1	8 x 11 m / 26 x 36 ft
MAYFAIR ROOM 2	9 x 7 m / 30 x 23 ft

ADDITIONAL

Lower ground floor, no natural daylight

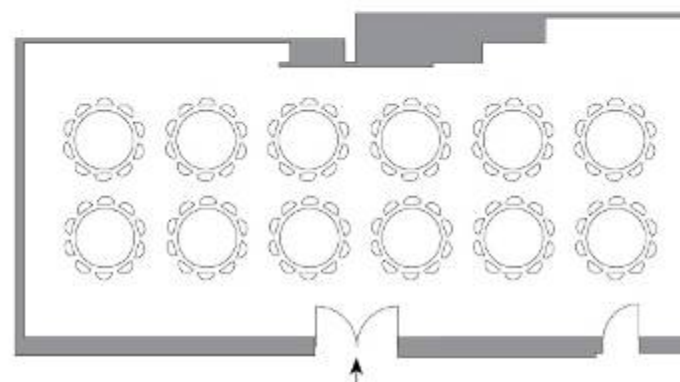

Dinner layout

Main entrance

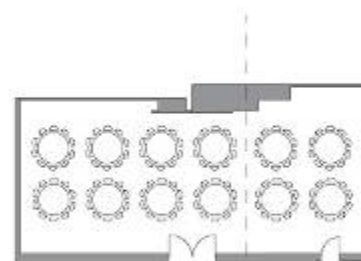

Mayfair Room 1

Mayfair Room 2

KEY

- Wall
- Window
- Single Door
- Double Doors

THE MAPLE ROOM

CONFIGURATIONS

Reception	100
Dinner	60
Board or Oval	36
Theatre	50
Classroom	32
Cabaret	30
U- Shape	20

MEASUREMENTS

Dimensions	13.5 x 6 m / 44 x 20 ft
Total Area	99 m ² / 1065 ft ²
MAPLE 1	9 x 8 m / 30x26 ft
MAPLE 2	4.5 x 6 m / 15 x 20 ft

ADDITIONAL

Ground floor, natural daylight

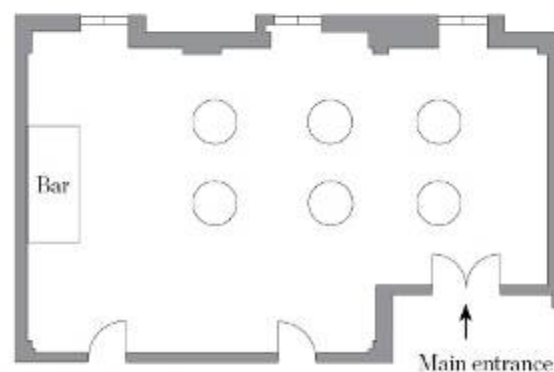

Reception layout

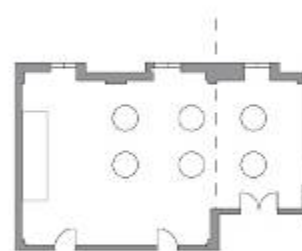

Maple Room 1

Maple Room 2

KEY

- Wall
- ▭ Window
- ∩ Single Door
- ∪ Double Doors

THE OAK ROOM

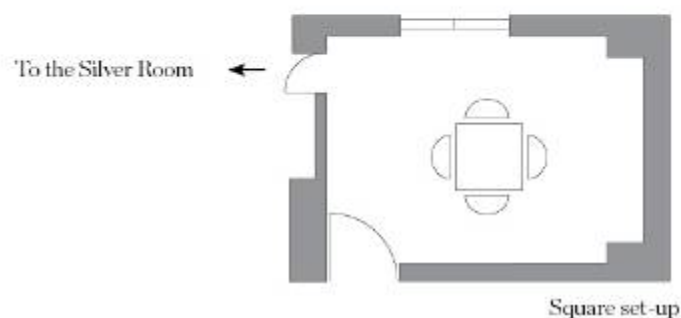

Square set-up

CONFIGURATIONS

Boardroom	4
Lunch / Dinner	6
Cocktail	8

MEASUREMENTS

Dimensions	3 x 4 m / 10 x 13 ft
Total Area	12 m ² / 129 ft ²

ADDITIONAL

Ground floor, natural daylight, viewing Moon Garden

KEY

	Wall
	Window
	Single Door
	Double Doors

THE SILVER ROOM

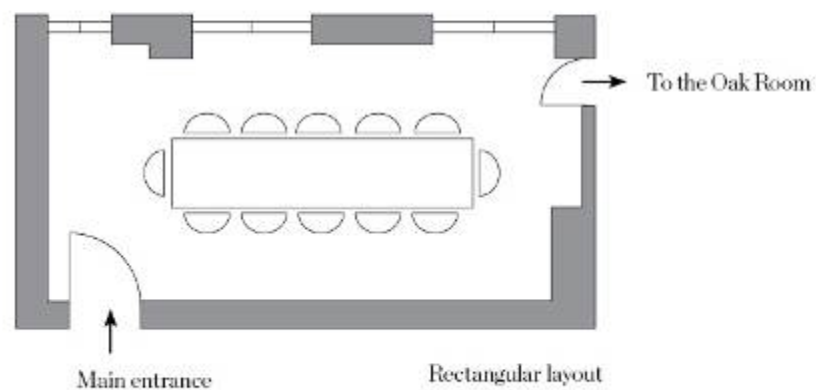
**CONFIGURATIONS**

Board / Lunch / Dinner	12
------------------------	----

MEASUREMENTS

Dimensions	3 x 6 m / 10 x 20 ft
Total Area	18 m ² / 194 ft ²

ADDITIONAL

Ground floor, natural daylight, viewing Moon Garden

KEY

- Wall
- ▭ Window
- ∩ Single Door
- ∪ Double Doors

THE REGENCY ROOM

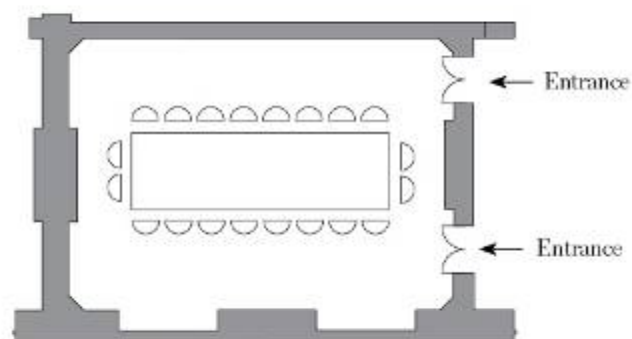

Dinner set-up

CONFIGURATIONS

Reception	40
Dinner	30
Oval	20
Theatre	20

MEASUREMENTS

Dimensions	8 x 5 m / 26 x 17 ft
Total Area	40 m ² / 442 ft ²

ADDITIONAL

Ground floor, no natural daylight

KEY

■	Wall
▭	Window
∩	Single Door
∪	Double Doors

THE GEORGIAN ROOM

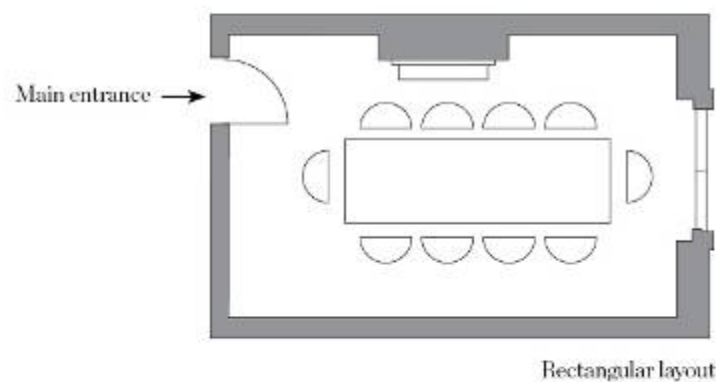
**CONFIGURATIONS**

Boardroom	Maximum of 10
Dinner	Maximum of 10

MEASUREMENTS

Dimensions	6 x 4 m / 19 x 13 ft
Total Area	24 m ² / 247 ft ²

ADDITIONAL

First floor, natural daylight

KEY

■	Wall
▬	Window
∩	Single Door
∪	Double Doors

THE CONNAUGHT BAR

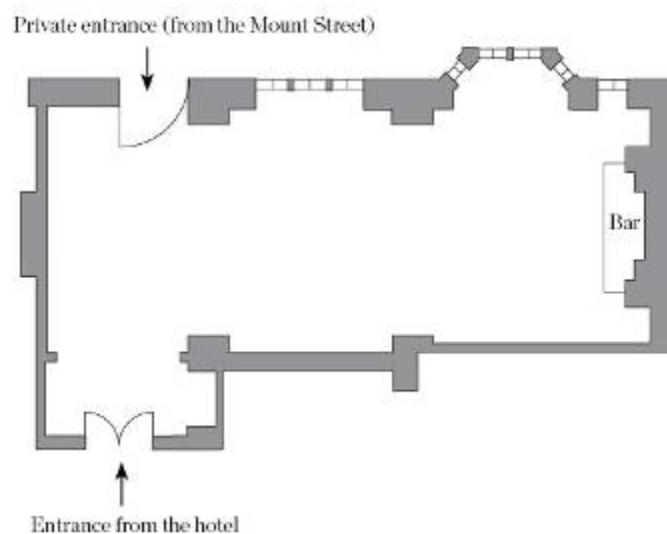
**CONFIGURATIONS**

Reception 80

ADDITIONAL

First floor, natural daylight

KEY

- Wall
- ▭ Window
- ∩ Single Door
- ∪ Double Doors